

# PRISMA

Concrete Paver

**BWS** BEST WAY  
STONE





## Installation Guide

**VB**  
VAN BEEK'S  
LANDSCAPE SUPPLY

[www.vanbeeks.com](http://www.vanbeeks.com)

# PRISMA NEW

SIGNATURE SERIES PAVER / 60MM /   



## BUNDLE OVERVIEW

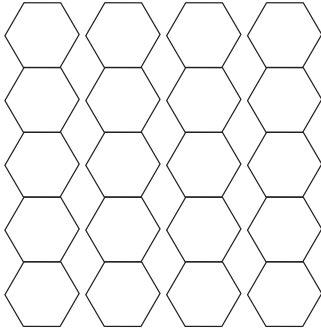

## UNIT

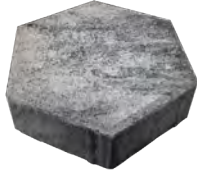

7.76" x 8.96" x 2.36"  
197mm x 227.5mm x 60mm  
Units/bundle: 180  
Units/layer: 20

## NOTES

The Prisma Paver blends timeless aesthetics with a modern twist, ideal for cutting-edge hardscape designs. Its elongated hexagonal form brings a distinctive geometric flair to landscaping, seamlessly integrating with various contemporary outdoor areas. Elevating projects, the Prisma introduces chic style and dimension.

## BUNDLE SPECIFICATIONS

### IMPERIAL

### METRIC

Coverage	65.16 ft <sup>2</sup>	6.05 m <sup>2</sup>
Weight	1800 lbs	816 kg
Layers	9	
Coverage per layer	7.24 ft <sup>2</sup>	0.67 m <sup>2</sup>
Lineal coverage	116.34 ft	35.5 m
Lineal coverage per layer	12.93 ft	3.94 m

## COLOURS

Carrara  
Ultra Black

## PATTERN

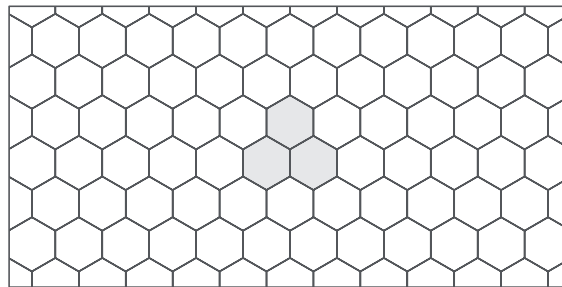

# INSTALLATION GUIDES - SLABS & PAVERS

## SLAB INSTALLATION TYPICAL CROSS SECTION

- 1 Best Way Stone® precast concrete slab 1 3/4" to 2" (45 to 60mm)
- 2 Sand joint fill
- 3 Bedding Sand 1" (25mm)
- 4 Geotextile 12" (300mm) wide
- 5 Plastic edge
- 6 Extra width equal to foundation thickness
- 7 Lawn
- 8 Nail
- 9 Compacted aggregate base 0 3/4" (0-20mm)
- 10 Geotextile
- 11 Subgrade

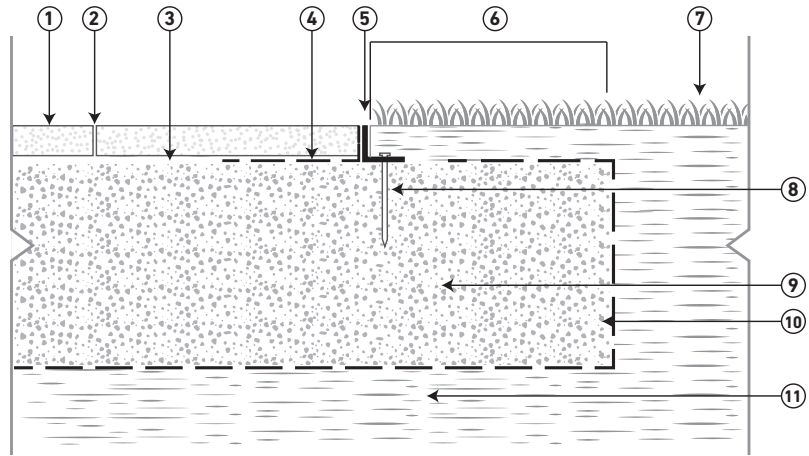

## SLABS ON PEDESTAL SET

- 1 Roof deck
- 2 Waterproof membrane
- 3 Protection board
- 4 Rigid insulation
- 5 Adjustable pedestal
- 6 Best Way Stone® precast concrete slab (2-2 1/2") (50-65mm) thickness conforming to ASTM C 1782 and CSA A231.1
- 7 Best Way Stone® precast concrete slab (2-2 1/2") (50-65mm) thickness conforming to ASTM C 1782 and CSA A231.1
- 8 Roof drain

When installing slabs on a pedestal set, ensure to consider load requirements. Refer to project engineer for specific considerations.

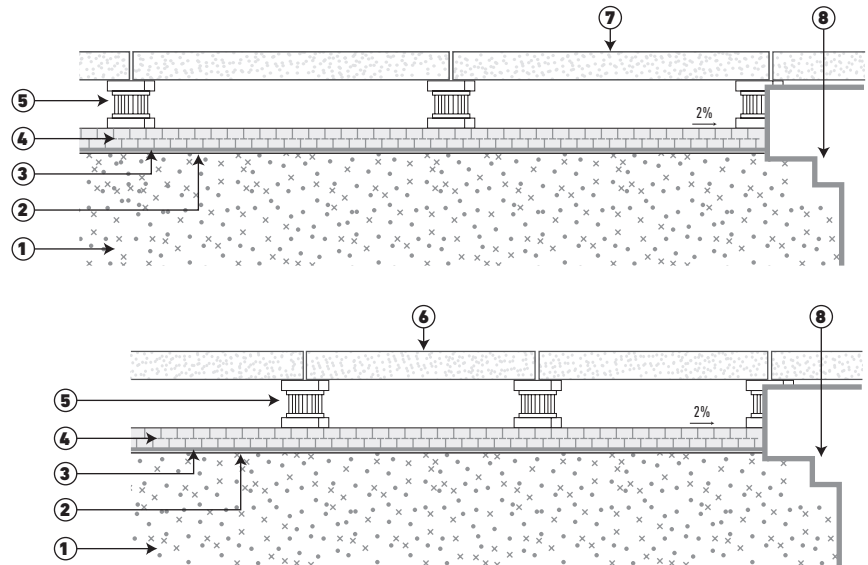

## TYPICAL PAVER CROSS SECTION WITH PLASTIC EDGE

- 1 Best Way Stone® precast concrete paver 2 3/8" (60mm) thick min.
- 2 Sand joint fill
- 3 Bedding Sand 1" (25mm)
- 4 Extra width equal to foundation thickness
- 5 Lawn
- 6 Plastic edge
- 7 Nail
- 8 Geotextile
- 9 Compacted aggregate base 0 3/4" (0-20mm)
- 10 Subgrade

